

# 2<sup>nd</sup> FLOOR

**LEGEND**

- ATM Machine
- Entrances
- Public Elevators
- Public Hallways
- Courtesy Phone
- Restrooms
- Service Elevators
- Stairs
- Vending Machines

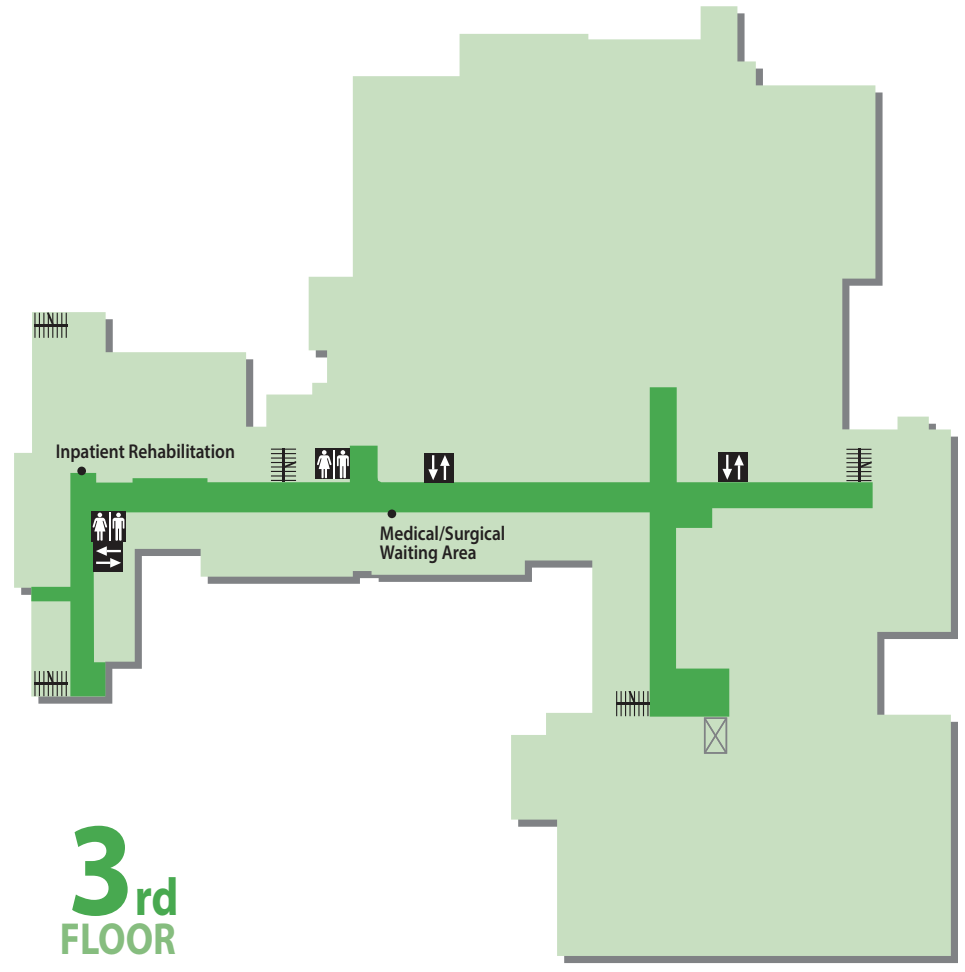

# 3<sup>rd</sup> FLOOR

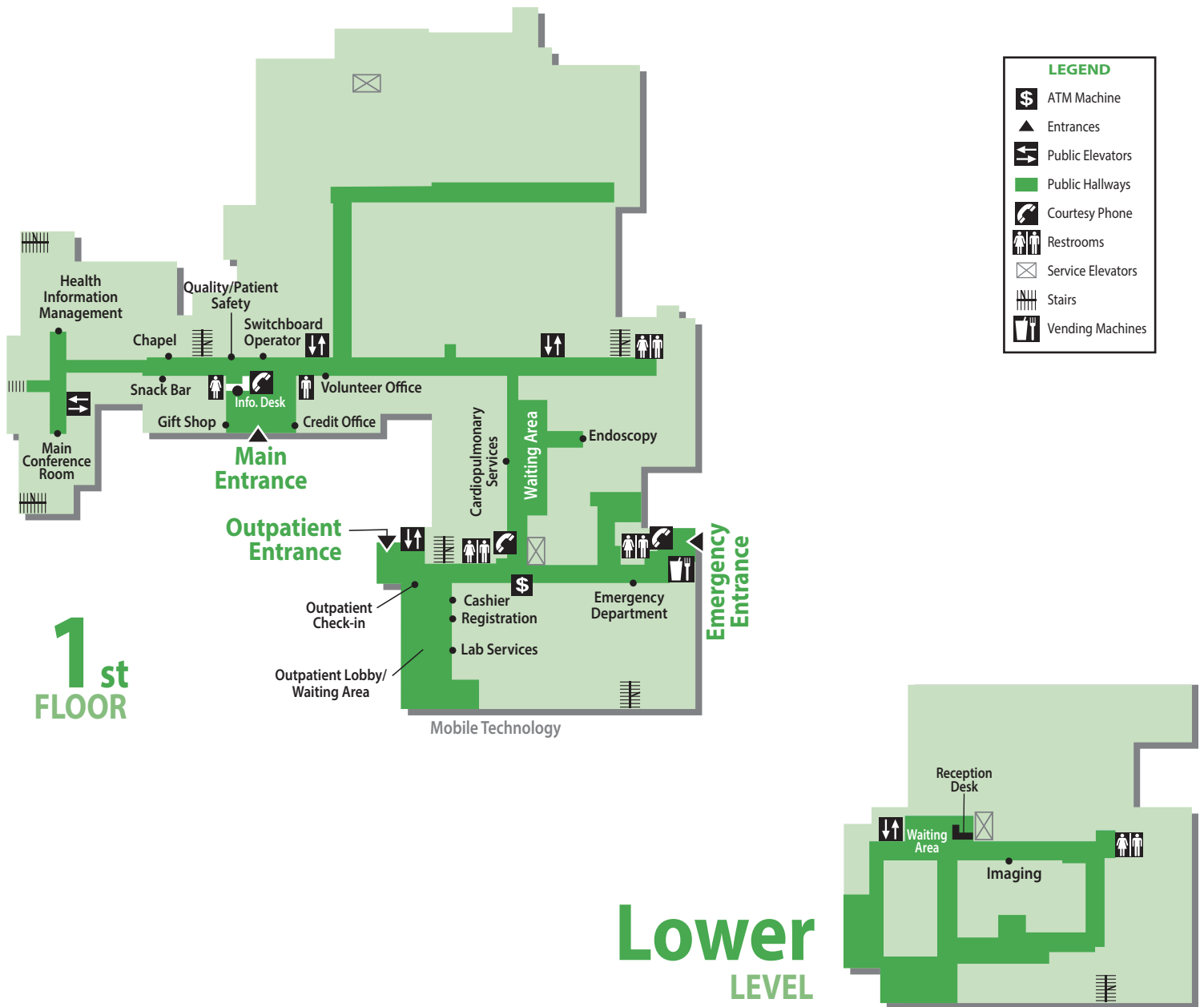

## Departments & Services

Cardiologist Office ( <i>Consultorio del Cardiólogo</i> )	2nd Floor
Cardiopulmonary Services ( <i>Servicios Cardiopulmonares</i> )	1st Floor
Credit Office ( <i>Oficina de Crédito</i> )	1st Floor
Day Surgery ( <i>Cirugía Ambulatoria</i> )	2nd Floor
<b>Emergency Department</b> ( <i>Departamento de Emergencias</i> )	1st Floor
Endoscopy ( <i>Endoscopia</i> )	1st Floor
Family Birthing Services ( <i>Servicios Familiares de Partos</i> )	2nd Floor
Gift Shop ( <i>Tienda de Regalos</i> )	1st Floor
Health Information Management ( <i>Administración de Información Médica</i> )	1st Floor
Human Resources ( <i>Recursos Humanos</i> )	2nd Floor
Imaging ( <i>Imagenología</i> )	Lower Level
Inpatient Rehabilitation ( <i>Rehabilitación para pacientes hospitalizados</i> )	3rd Floor
Intensive Care ( <i>Atención Intensiva</i> )	2nd Floor

Main Lobby ( <i>Vestíbulo Principal</i> )	1st Floor
Medical / Surgical Waiting Area ( <i>Áreas de Espera Médico-Quirúrgicas/ Sala de Espera Quirúrgica</i> )	3rd Floor
Outpatient Check-in ( <i>Inscripción de Pacientes Ambulatorios</i> )	1st Floor
Outpatient Lobby / Waiting Area ( <i>Vestíbulo/Área de Espera de Pacientes Ambulatorios</i> )	1st Floor
Pre-Admission Testing ( <i>Pruebas de Preadmisión</i> )	2nd Floor
Quality/Patient Safety ( <i>Calidad/Seguridad de paciente</i> )	1st Floor
Snack Bar ( <i>Cafetería</i> )	1st Floor
Volunteer Office ( <i>Oficina del Voluntariado</i> )	1st Floor
Wound Care Center ( <i>Centro de Cuidado de Heridas</i> )	2nd Floor